

HEMA 4106

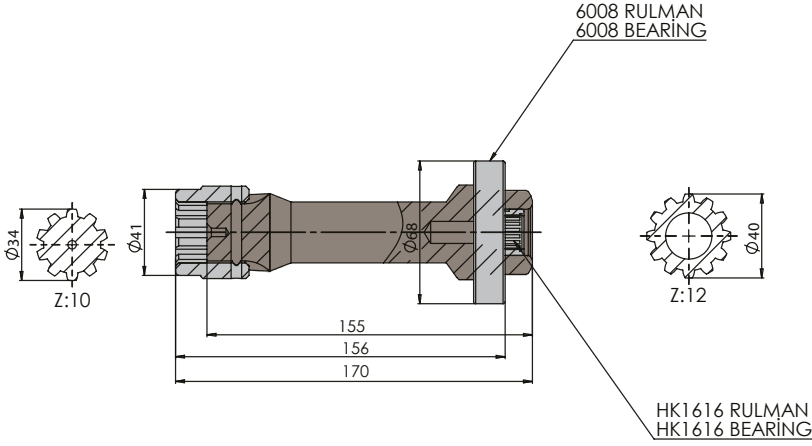

60404106

GEARBOX ANA ŞANZIMANLAR	USED VEHICLES KULLANILAN BAZI ARAÇLAR
PTO EATON FS/FSO/H/V 4106-5206 A/B/H	180-617-620-622 BMC PRO / 200.26-180 FATİH BMC2520 FORD CARGO / AS 950 / CHRYSLER 180.12-210-220 CD-320 MIDLUM RENAULT /FODEN 2000 /ERF E6.18 / 1415-1718 FORD 8.163- 8.224-18-224 MAN/ FEDON ATKINSON E6.11 /

CARDAN SHAFTS
KARDAN MİLLERİ

HEMA 6109 - 8209

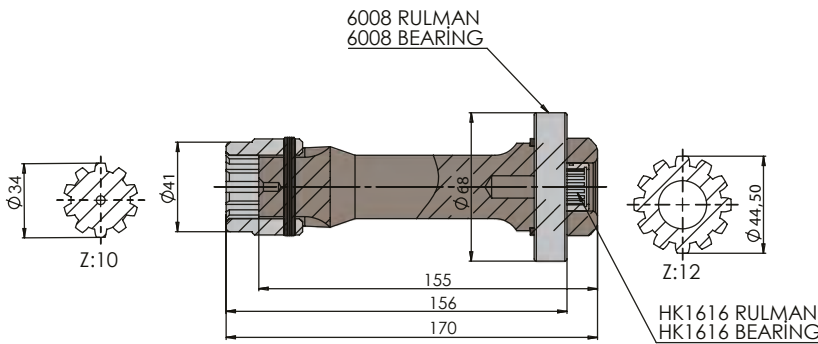

60406109

GEARBOX ANA ŞANZIMANLAR	USED VEHICLES KULLANILAN BAZI ARAÇLAR
EATON FS/FSV/FSO/H/V 6109(6,59-8,81-12,64)-6209-8209(8,76-12,57) FS/FSV/ FSO/H/V 5109- 6309-8309 (7,84-6,59-8,76-9,45-12,637) A EATON ES 11109 DD (8,81) - ES 11109 LH ESO 14409 EATON ESO 14409 FORD 2018	214.26-220.26-280 FATİH / 2520L-2621 FORD CARGO / 522-822-620 BMC 280 / FODEN 3000 26.234-26.264-26.284 MAN 6X2 EURO / SEDDON 211 / NISSAN CPC 16 / RENAULT MIDLUM 270 TATA LPTA 1621 TC 6x6-LPS 4021 TC / ERF ES6 / 1626 JAC MİSİR / AMW INDIA 4930- 4018-2518 ISUZU FXZ 23 / HINO FM1JNRA-JNPD-JKPA-GVW 26T / MITSUBISHI M527M2L / 527M3L / FN 627 NISSAN UD177ETN-CWA211MHRR-CWA214-CPC16 / HINO 500 SERIES GH1JLPD EURO 2 / 18.264 MAN Mitsubishi Fighter-280-FU281U8 / Fighter-280-FN281U8 / Fighter-280-FM280H8 / Fighter-FM281M8 3233 S FORD CARGO 2018 / 1833 FORD CARGO 2018

HYDRAULIC EQUIPMENT
HİDROLİK EKİPMANLAR